

FORK/TERMINAL UNF

High Polished Stainless Steel - AISI 316 - Chromed Bronze Body

ART.NO.	THREAD G	WIRE	PIN	A	B	L1	L2	BL/KG	KG/100	PACK
130306A	1/4"	3,0 1/8"	6,35 9,5	13	236	174	1300	10,7	10	
130406A	1/4"	4,0 5/32"	6,35 9,5	13	246	184	1300	11,0	10	
130408A	5/16"	4,0 5/32"	8,0 11	15	280	204	1700	14,5	10	
130508A	5/16"	5,0 3/16"	8,0 11	15	286	210	2200	14,7	10	
130510A	3/8"	5,0 3/16"	9,5 12	19	317	233	2400	23,2	10	
135510A	3/8"	7/32"	9,5 12	19	325	241	3400	24,5	10	
130611A	7/16"	6,0	11,0 12	23	365	275	4600	36,5	5	
130711A	7/16"	7,0 9/32"	11,0 12	23	370	280	4600	34,5	5	
130612A	1/2"	6,0	12,7 14	25	397	291	5400	55,0	5	
136312A	1/2"	1/4"	12,7 14	25	397	291	5200	55,0	5	
130712A	1/2"	7,0 9/32"	12,7 14	25	405	299	6100	55,5	5	
130816AX	5/8"	8,0 5/16"	16,0 18	33	496	364	8700	109,5	BULK	
131016AX	5/8"	10,0	16,0 18	33	509	375	9700	113,7	BULK	
139520A	3/4"	3/8"	19,0 24	48	591	431	10200	191,0	BULK	
131020A	3/4"	10,0	19,0 24	48	591	431	9700	191,0	BULK	
131220A	3/4"	12,0	19,0 24	48	606	446	11400	194,0	BULK	
* 131220AX	3/4"	12,0	19,0 24	48	626	466	14000	196,0	BULK	
* 131320A	3/4"	1/2"	19,0 24	48	627	467	12900	196,0	BULK	
131422A	7/8"	14,0	22,0 26	56	794	600	15900	304,0	BULK	
131625A	1"	16,0 5/8"	25,4 29	62	940	700	19400	445,0	BULK	
131927A	1 1/8"	19,0 3/4"	28,0 32	68	969	721	23000	719,5	BULK	

* Note: Terminal OD. = 21,4 mm

Note: All break loads are determined by clevis pin and thread.

The user is responsible for choosing the proper cable diameter and for correct assembly.

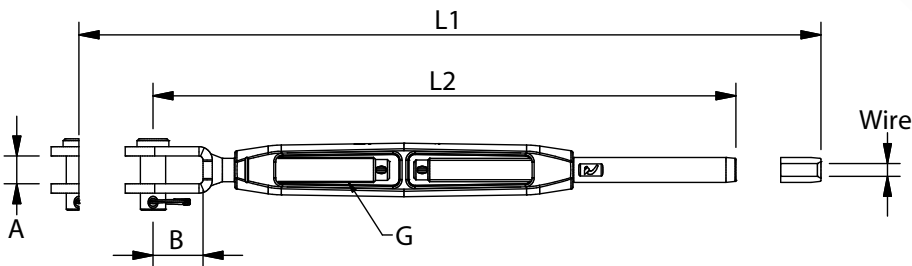

The Blue Wave Chromed Bronze Body features a number of details that makes it the best choice for exclusive and durable rigging. The sleek, open Bronze body prevents the threads from seizing up, they are delivered with laser engraved thread size, Blue Wave logo, and side marking of the left thread.



TOGGLE/FORK UNF

High Polished Stainless Steel - AISI 316 - Chromed Bronze Body

ART.NO.	THREAD G	PIN	A1	A2	B1	B2	L1	L2	BL/KG	KG/100	PACK
330006A	1/4"	6,35	8	10	17	13	225	163	1300	12,8	10
330008A	5/16"	8,0	10	11	20	15	268	192	2200	20,5	10
330010A	3/8"	9,5	12	12	26	19	313	229	3400	32,5	5
330011AX	7/16"	11,0	15	12	28	23	350	260	4600	54,0	5
330012AX	1/2"	12,7	18	14	35	25	382	276	6100	80,0	5
330016AX	5/8"	16,0	20	18	41	33	491	359	9900	137,0	BULK
330020AX	3/4"	19,0	24	24	45	48	586	426	14400	228,0	BULK
330022AX	7/8"	22,0	26	30	49	56	710	516	19600	410,0	BULK
330025AX	1"	25,4	29	30	59	62	835	595	21400	575,0	BULK

