

## MONO RACE TUNING - MRT - CALIBRATED

High Polished Stainless Steel - AISI 316 - Toggle/Wire Terminal

ART.NO.	WIRE	THREAD	G	A	B	L1	L2	PIN	BL/KG	PACK	KG/100
MRT03014	3,0	1/4"	8	17	233	193	6,35	1300	BULK	11,4	
MRT32014	1/8"	1/4"	8	17	233	193	6,35	1300	BULK	11,4	
MRT04014	4,0 5/32"	1/4"	8	17	256	216	6,35	1300	BULK	12,2	
MRT04516	4,0	5/16"	10	20	271	221	8,0	1700	BULK	19,2	
MRT05516	5,0 3/16"	5/16"	10	20	277	227	8,0	2200	BULK	20	
MRT05038	5,0	3/8"	12	26	323	263	9,5	2400	BULK	35,1	
MRT06716	6,0	7/16"	15	28	353	283	11,0	4600	BULK	56,3	
MRT06012	6,0	1/2"	18	35	414	334	12,7	5400	BULK	79,9	
MRT63012	1/4"	1/2"	18	35	414	334	12,7	5200	BULK	80,4	
MRT07716	7,0	7/16"	18	28	375	305	11,0	4600	BULK	60,2	
* MRT07012	7,0	1/2"	18	35	422	342	12,7	6100	BULK	80,5	
* MRT08012	8,0	1/2"	18	35	436	356	12,7	6100	BULK	84,4	
* MRT08058	8,0	5/8"	20	41	510	410	16	8700	BULK	142,8	
* MRT10058	10,0	5/8"	20	41	561	461	16	9700	BULK	146,4	
* MRT10034	10,0	3/4"	24	45	598	478	19	9700	BULK	260	
*! MRT12034	12,0	3/4"	24	45	629	509	19	14200	BULK	273	
* MRT14078	14,0	7/8"	26	49	698	568	22	15900	BULK	420,5	
* MRT16110	16,0	1"	29	59	820	660	25,4	19400	BULK	616,4	

! Note: Terminal OD. = 21,4 mm

The user is responsible for choosing the proper cable diameter and for correct assembly.  
MRT´s marked with "\*" on request only

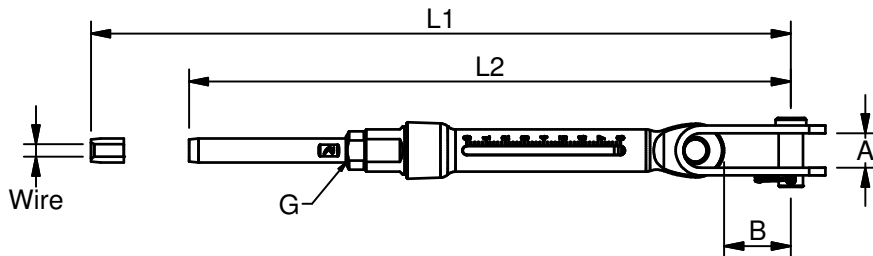

A highly sophisticated rigging screw, from the Blue Wave racing line. It features an adjustment nut in black chromed high quality alu bronze, engraved calibration scale for fast and accurate adjustment of the rig tension and an extra length thread terminal.

## MONO STANDARD TUNING - MST

High Polished Stainless Steel - AISI 316

ART. NO.	WIRE	THREAD	G	PIN	A	B	L1	L2	BL/KG	PACK	KG/100
MST03014	3	1/4"	6,35	8	17	233	193	1300	BULK	11,8	
MST32014	1/8"	1/4"	6,35	8	17	233	193	1300	BULK	11,8	
MST04014	4 5/32"	1/4"	6,35	8	17	256	216	1300	BULK	12,6	
MST04516	4 5/32"	5/16"	8,0	10	20	271	221	1700	BULK	19,7	
MST05516	5 3/16"	5/16"	8,0	10	20	277	227	2200	BULK	20,5	
MST05038	5 3/16"	3/8"	9,5	12	26	323	263	2400	BULK	36,1	
MST06716	6	7/16"	11,0	15	28	375	305	4600	BULK	57,5	
MST06012	6	1/2"	12,7	18	35	414	334	5400	BULK	81,7	
MST07716	7 9/32"	7/16"	11,0	15	28	353	283	4600	BULK	60	
* MST07012	7 9/32"	1/2"	12,7	18	35	422	342	6100	BULK	82,2	
* MST08012	8 5/16"	1/2"	12,7	18	35	436	356	6100	BULK	86,1	
* MST08058	8 5/16"	5/8"	16,0	20	41	510	410	8700	BULK	146,9	
* MST10058	10	5/8"	16,0	20	41	561	461	9700	BULK	150,5	
* MST10034	10	3/4"	19,0	24	45	598	478	9700	BULK	264,7	
*! MST12034	12	3/4"	19,0	24	45	629	509	14200	BULK	277,8	
* MST14078	14	7/8"	22,0	26	49	698	568	15900	BULK	425,7	
* MST16110	16	1"	25,4	29	59	820	660	19400	BULK	622,8	

! Note: Terminal OD. = 21,4 mm

The user is responsible for choosing the proper cable diameter and for correct assembly.

MST´s marked with "\*" on request only

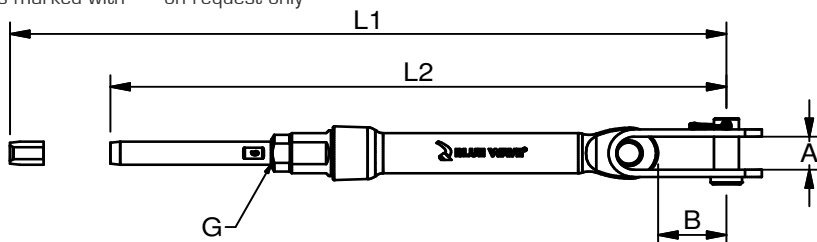

Toggle/Wire Terminal  
A highly sophisticated rigging screw. A price favourable alternative to the Blue Wave racing line, with all the features except the calibration scale. It features an adjustment nut, in chromed high quality alu bronze, and an extra length thread terminal.