

## "U" BOLTS

Polished Stainless Steel - AISI 316

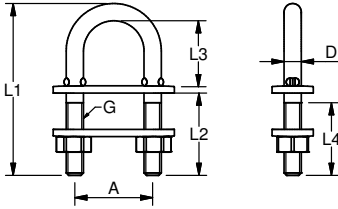

ART. NO.	G	A	D	L1	L2	L3	L4	B.L./KG	KG/100	PACK
340435	M4	30	4,0	66	35	25	30	750	2,1	25
340535	M5	30	4,4	67	35	25	30	900	2,6	25
340635	M6	33	5,3	67	35	26	30	1250	4,5	5
340650	M6	33	5,3	84	50	26	30	1250	5,7	5
340835	M8	33	7,1	71	35	26	30	1750	7,2	5
340850	M8	33	7,1	86	50	26	30	1750	9,7	5
340880	M8	33	7,1	116	80	26	45	1750	11,8	5
348840	M8	50	8,0	80	40	30	32	1750	12,4	5
348850	M8	50	8,0	90	50	30	32	1750	13,2	5
341045	M10	40	10,0	95	45	40	40	3500	18,4	5
341060	M10	40	10,0	110	60	40	35	3500	20,4	5
341010	M10	40	10,0	150	100	40	85	3500	25,0	5
341280	M12	47	10,8	122	80	30	85	5100	29,0	5

Note: All breakloads are determined by thread

## EYE STRAPS

Polished Stainless Steel - AISI 316



Eye straps are used for various attachments and fixing points. Place it over two pre-drilled holes and if possible use a pop rivet for easy attachment.

ART. NO.	H	A1	A2	D1	D2	KG/100	PACK
150401	12	28	11	4.2	9	0.3	100
155102	13	34	15	5.0	11	0.5	100
155203	19	44	20	5.3	12	1.0	100
155304	24	64	28	5.3	10	1.2	50
156205	29	69	32	6.4	14	2.0	50

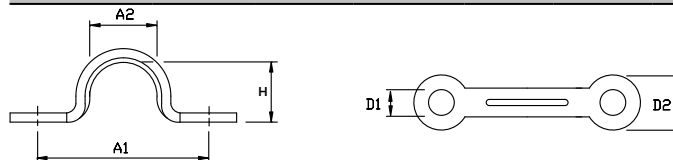

## STRAP - EYE

High Polished Stainless Steel - AISI 316



ART. NO.	D1	D2	D3	L1	L2	L3	B.L./KG	KG/100	PACK
150404	4,2	9	7	15	4,7	1,5	500	0,3	100
150505	5,0	11	10	24	7,3	2,0	1000	0,8	100

